

in atrio
ianua, fauces, ostium = door
aperire ≠ *claudere*; *ingredi* ≠ *egredi*
scaliae, -arum = stairs
ascendere ≠ *descendere*
versor, -arum ≈ *sum, esse*
ego in atrio versor.
in cubiculo / conclave
lectus aut torus, -i = bed
pulvinus, -i aut pulvinar, -aris (n) = pillow
stragulum, -i = bedclothes (sheet, blanket, etc)
stragulum lanæum, -i = woollen blanket
lōdix, lōdixis (f) = blanket
lectum insernere / lecti stragula componere = to make the bed
cubium ire / dormitum ire = to go to bed
arnarium, -i = chest of drawers
loculus receptus, -i = drawer
transenna, -ae = blinds
excipulum, -i / *scripculus, -i* = trash can

in balneo
labellum, -i = sink
peniculus dentarius, -i = tooth brush
dentis fricare = to brush teeth
balneum pluvium, -i = shower
balneo pluvio uti = to take a shower
pyelis, -i / labrum, -i = bath tub
pyelo uti = to take a bath
lavor, lavari = to wash oneself
manutergium, -i = towel
faciergium, -i = wash cloth
nasitergium, -i = tissue
sella perusa / familiarica, -ae = toilet
ad secessum / debet secedere / mi secedendum *si* = to express the need to go
charta hygienica, -ae / antiergium, -i = toilet paper
vesticam exonerare = to empty the bladder
micurō, -ire = to need to pee
mingō, -ere, mī(n)xi, mī(n)ctum = to pee
caecū, cacare = to need to pee

in mediāno
pēgma, pēgmatis (n) / *pluteus, -i* = bookcase
sponda, -ae = couch
tapete, tapetis (n) = carpet
lampas, lampadis (f) = light
accende lampades = turn on the lights
extingue lampades = turn off the lights
epitonium, -i = light switch
machina (-ae) aëris temperandi = air conditioner
magnētoscopium digitalis discuti = DVD player
quadrum / quadrum = screen
in culina
frigidarium, -i = refrigerator
gelatorium, -i = freezer
penus, -us (n) / *pendarium, -i* = cupboard
loculus receptus, -i = drawer
elatorium, -i = dishwasher
fursorium, -i = kitchen sink
vasa (copulativa) (n) = pots/pans

in triclinio / refectorio / cenatio
esse = *consumere*
bibere = *potare*
tenare = *tenaculum consumere*
prandere = *prandium consumere*
cenare = *cenam consumere*
promissis, -idis (f) = *cibi ante cenam*
vasa escartia:
poculum, -i = (coffee) mug
hyalus, -i = glass
calix, -icis (m) = wine glass (with stem)
patella / patina, -ae = plate
lanx, lancis (f) = platter
catinus, -i / *paropsis, idis* (f) = bowl
pyxis, pyxidis (f) = can
lagena, -ae = bottle
instrumenta escartia:
cullillus, -i = knife
fuscina, -ae aut fuscinus, -i = fork
cochlear, -aris (n) = spoon

in laboratoriō computatoriō

computatorium / computatrum, -i = computer
computatorium / computatrum portabile, -i = laptop computer
quadrum = screen
claviatūra, -ae = keyboard
impressorium, -i = printer
interrēte, -is (n) = internet
situs, -ūs interrētialis (m) = web site
fenestella, -ae = window
(dē)volvere = to scroll (down)
īscriptiō cursuālis, -ōnis -is (f) = email address
vestēs / vestimenta
indusium, -i = t-shirt
camīsia, -ae = button down shirt
globulus, -i = button
ocellus, -i = button hole
manica, -ae = sleeve
subūcula, -ae = tank top

quid interest inter indusium et camīsiā?
camīsia habet globulōs et ocellōs.
bracae, -arum = pants
bracae genuēnsēs = jeans
bracae brevēs = shorts
bracae dormitōriæ = pj bottoms
vestis dormitōria = nightclothes
subligar, -aris (n) *aut subligaculum* = underwear
strophium, -i aut mamillāre, -is (n) = bra
sandalia, -orum = sandals (with covered toes)
soleae, -arum = simple sandals (thong)
calcei (athlētici), -orum = tennis shoes
impīlia, -orum = short socks
tībiālia, -orum = long socks
bīna impīlia = pair of short socks
petasus, -i = hat with brim
pileus lūsōrius = baseball hat
oculāria aut perspiculum = glasses
lenticulae adhaerentēs = contact lenses
gerō, gerere = to wear
induō, induere ≠ *exuō, exuere*

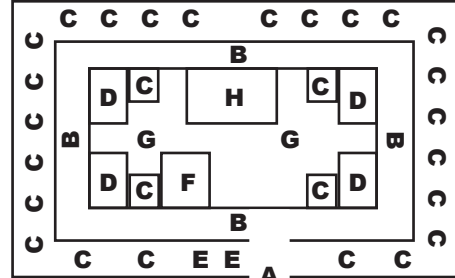

Aedēs Linguae Familiae Jordaniēnsis
A *iānua, -ae* = (front) door
B *ambulācrum, -i / andron, -ōnis* (m) = hallway
C *cubiculum, -i* = (dorm) room
D *mediānum, -i* = commons room (living room)
E *laboratoriū computatoriū* = computer lab
F *culīna et triclinium* = kitchen & dining room
G *hortus, -i / area, -ae* = garden/inner courtyard
H *māchina vēnditōria et lavandāria* = vending & washing machines

Meus Libellus
pro
Conloquio Aestivo
Conlegii Austiniensis

ego gratias maximas
Annulae Llewellynae,
Patricio Oeno, Davido Morgano,
Stephano Berardo et
Iohanni Traupviro ago.
omnes errores sunt mei.

Ginnia Lindzea me fecit.